

Cement : Sand - 1 : 4
 Cement : Sand : Aggregates - 1 : 1.5 : 3

Refer "Mason Guide For Improving Earthquake Resistance Of Non - Engineered Construction For The Districts Of Himachal Pradesh" for reinforcement details in seismic bands.

Developed by:



Department of Civil Engineering
 National Institute of Technology, Hamirpur
 Himachal Pradesh

OWNER'S GUIDE FOR CONSTRUCTION OF NON - ENGINEERED BUILDINGS



HIMACHAL PRADESH STATE
 DISASTER MANAGEMENT AUTHORITY
 Govt. of Himachal Pradesh

SEISMIC BANDS

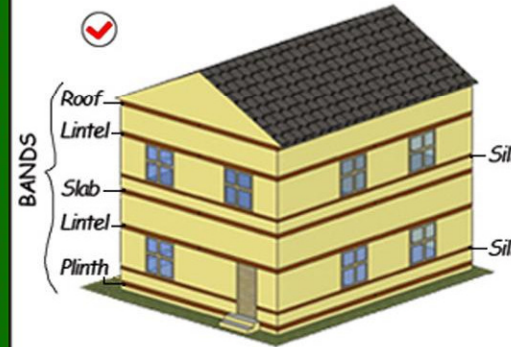

ROOF TRUSS BRACING

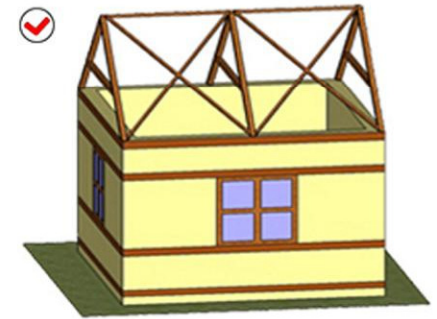

VERTICAL IRREGULARITIES

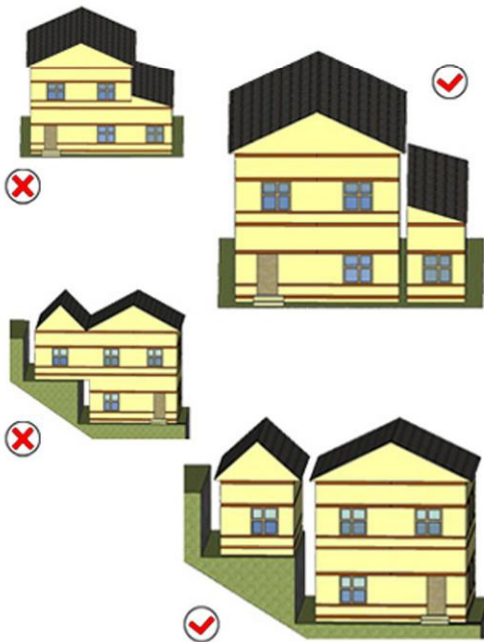

DETACHED STAIR CASE

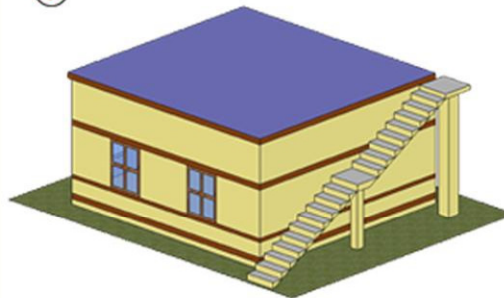
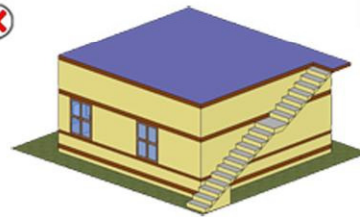

OPENING'S DISTANCE FROM CORNER



PLAN IRREGULARITIES

